

Faucet Aerator - 2.2 gpm max Pressure Compensating Tiny Junior Size

NEOPERL®

flow, stop and go®

Features and Benefits

- ▶ Watercolours® design: Color coding to identify flow rate and stream pattern.
- ▶ Patented construction provides a splash-free stream, well-aerated and soft to the touch.
- ▶ Pressure compensating for constant flow from 20 to 80 psi.
- ▶ Integrated anti-liming honeycomb replaces conventional wire mesh screens prone to lime build up.
- ▶ Anti-clogging dome screen filters sediment and particles.
- ▶ Available housing finishes: chrome.

Certifications

ANSI/ NSF® -61-372 (pending)
ASME A112.18.1M and CSA B125 (pending)
Meets CALGreen requirements

Thread & Part Number

Part #	Designation	Thread Size
TSA-220INTJ-P	Insert only	
TSA-220MTJ-P	Tiny Junior male	M20x1
TSA-220FTJ-P	Tiny Junior female	M19x1

Packaging:

Inserts 1 pc (bag), 6 pcs (bag), 50 pcs (bag)
Tiny Junior male/female 1 pc (bag), 6 pcs (tube), 50 pcs (tray)

Color Code

Dome	Flow Regulator	Basket
Natural	Yellow	Dark Gray

Flow Rate Curve

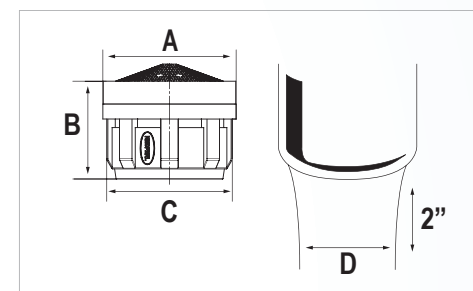
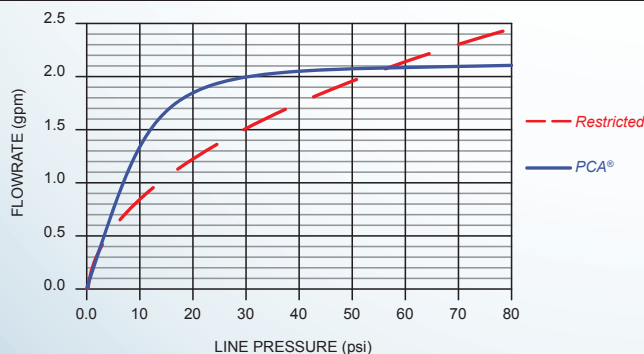

Dimensions

No	mm	In
A	17.1	0.673
B	11.25	0.443
C	16.1	0.634
D	≈ 11	≈ 7/16

Housings

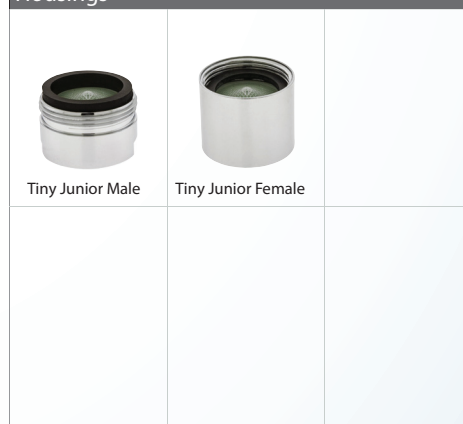

Technical Data

Materials: Body Acetal
Washer EPDM
O-ring EPDM

Continuous

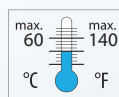

Short-term (5 minutes max.) Per ASME A112.18.1 testing requirements.

