

PCA® Perlator

Laminar Stream - 1.0 gpm max
Pressure Compensating Tom Thumb® Size



flow, stop and go®

Features and Benefits

- ▶ Watercolours® design: color coding to identify flow rate and stream pattern.
- ▶ Patented construction provides a splash-free, crystal clear (non-aerated) stream.
- ▶ Pressure compensating for constant flow from 20 to 80 psi.
- ▶ Recommended for use in healthcare facilities to prevent mixing air and water.
- ▶ Integrated anti-liming honeycomb replaces conventional wire mesh screens prone to lime build up.
- ▶ Anti-clogging dome screen filters sediment and particles.
- ▶ Available housing finishes: chrome.
- ▶ Roll marked with statutory marks.

Certifications

ANSI/ NSF® -61-372
ASME A112.18.1M and CSA B125
Meets **CALGreen** requirements
WaterSense



Thread & Part Number

Part #	Designation	Thread Size
TSL-100INTT-P	Insert only	
TSL-100MTT-P	Tom Thumb® male	M18x1
TSL-100FTT-P	Tom Thumb® female	M16x1

Other product combinations available.

Packaging:

Inserts 1 pc (bag), 6 pcs (bag), 50 pcs (bag)
Tom Thumb® male/female 1 pc (bag), 50 pcs (tray)

Color Code

Dome	Flow Regulator	Basket
Clear	Blue	Light Gray

Flow Rate Curve

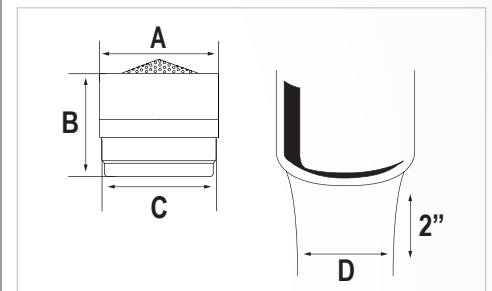
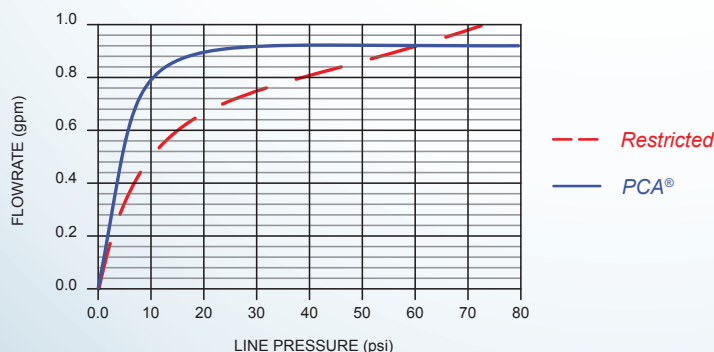

Dimensions

No	mm	In
A	15.00	.591
B	12.95	.510
C	14.05	.553
D	≈ 9	≈ 3/8

Housings



Tom Thumb® Male



Tom Thumb® Female

Technical Data

Materials: Body Acetal
O-ring EPDM
Washer NBR

Continuous

max. 60 °C
max. 140 °F
90psi max.
6.2bar max.

Short-term (5 minutes max.) Per ASME A112.18.1 testing requirements.

max. 70 °C
max. 160 °F
125psi max.
8.5bar max.